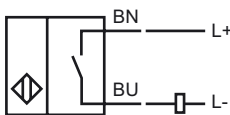
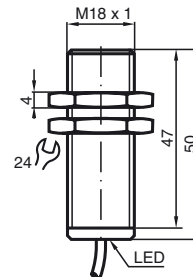

**Model Number**

NBB5-18GM50-Z0

**Features**

- Basic series
- 5 mm embeddable

**Connection****Dimensions****Technical Data****General specifications**

Switching element function	DC	Make function
Rated operating distance	$s_n$	5 mm
Installation	embeddable	
Output polarity	DC	
Assured operating distance	$s_a$	0 ... 4.05 mm
Reduction factor $r_{Al}$	0.32	
Reduction factor $r_{Cu}$	0.31	
Reduction factor $r_{V2A}$	0.72	

**Nominal ratings**

Operating voltage	$U_B$	6 ... 60 V
Switching frequency	$f$	0 ... 1500 Hz
Hysteresis	$H$	1 ... 15 typ. 6 %
Reverse polarity protection	tolerant	
Short-circuit protection	no	
Voltage drop	$U_d$	$\leq 6$ V
Operating current	$I_L$	4 ... 100 mA
Off-state current	$I_r$	0 ... 1 mA typ. 0.7 mA
Indication of the switching state	all direction LED, yellow	

**Standard conformity**

Standards	IEC / EN 60947-5-2:2004
-----------	-------------------------

**Ambient conditions**

Ambient temperature	-25 ... 70 °C (248 ... 343 K)
---------------------	-------------------------------

**Mechanical specifications**

Connection type	2 m, PVC cable
Cable version	PA
Core cross-section	0.34 mm <sup>2</sup>
Housing material	brass, nickel-plated
Sensing face	PBT
Protection degree	IP67